

# GPX 70 Ø70 mm, planetary gearhead

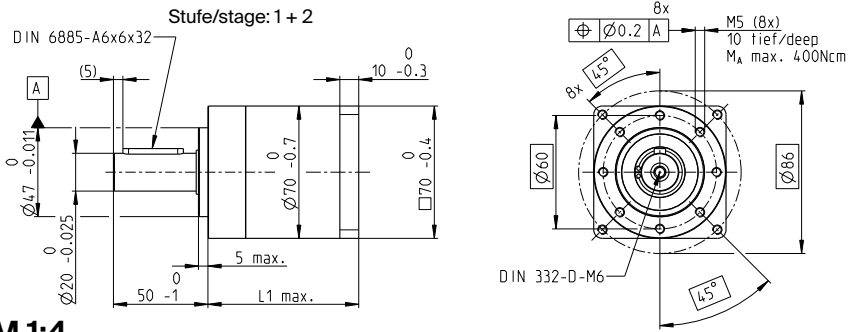

GPX



## M 1:4

Key data		LN Noise reduced	
Max. transmittable power	W	700	
Max. continuous torque	Nm	27.0	
Max. continuous input speed	rpm	6000	
Ambient temperature	°C	-20...+85	
Bearing at output		Ball bearing	
Typical noise level	dBA	-5 dBA compared to standard configuration	

## Operating range (output shaft)

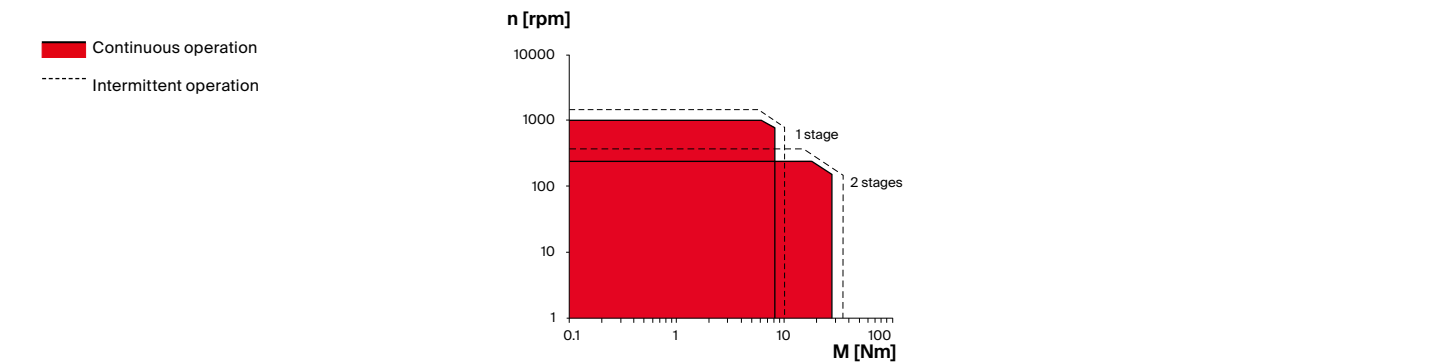

Specifications		LN Noise reduced	
Number of stages		1	2
Max. transmittable power (continuous)	W	700	450
Max. transmittable power (intermittent)	W	875	563
Max. continuous torque	Nm	8.0	27.0
Max. intermittent torque	Nm	10.0	34.0
Max. continuous input speed	rpm	4000	4000
Max. intermittent input speed	rpm	6000	6000
Max. efficiency	%	95	92
Average backlash no load	°	0.5	0.5
Max. axial load (dynamic)	N	825	825
Max. permissible radial load, 10 mm from flange	N	1000	1200
Gearhead length L1 <sup>†</sup>	mm	58	80
Weight	g	945	1380

Configuration		LN Noise reduced	
Number of stages		1	2
Reduction		3.9, 5.3, 6.6	16, 21, 26, 28, 35, 44
Version		Standard/noise reduced/ultra performance	
Flange		Standard flange	
Shaft			

Modular system		Page	Compact drive		Page
EC motor	N° of stages [opt.]			N° of stages [opt.]	
IDX 70 S	1-2	252	IDX 70 S	1-2	356
IDX 70 M	1-2	253	IDX 70 M	1-2	357

<sup>†</sup>This length may vary depending on the configuration and choice of motor. The effective length is calculated at the end of the configuration process.