

Sterilizable

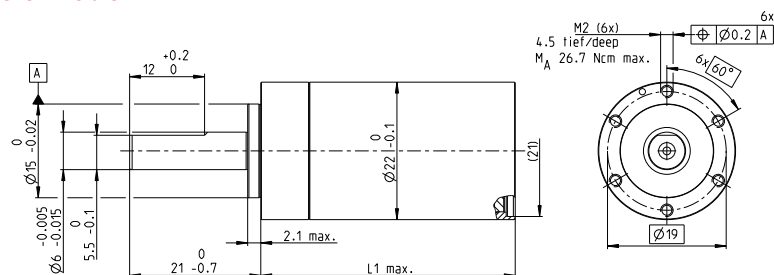

GPX

Key data		With shaft seal
Max. transmittable power	W	60
Max. continuous torque	Nm	3.3
Max. continuous input speed	rpm	10000
Ambient temperature	°C	-10...+135
Bearing at output		Ball bearing

■ Continuous operation
--- Intermittent operation

With shaft seal: typically 2000 autoclave cycles

Sterilization with steam

Sterilization Temperature

Temperature
Compression pressure up to

Rel. humidity

Rel. humidity
Cycle length

134°C ±4°C

2.3 bar

2.5 Dal
100%

18 minutes

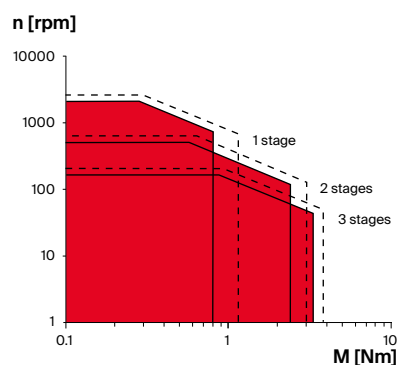

Specifications		With shaft code		
		1	2	3
Number of stages		60	30	15
Max. transmittable continuous power	W	80	40	20
Max. transmittable intermittent power	W	0.8	2.4	3.3
Max. continuous torque	Nm	1.15	3.0	3.8
Max. intermittent torque	Nm	8000	8000	10000
Max. continuous input speed	rpm	10000	10000	12500
Max. intermittent input speed	rpm	85	75	65
Max. efficiency	%	0.85	1.05	1.2
Average backlash no load	°	80	80	80
Max. axial load (dynamic)	N	45	75	100
Max. radial load, 10 mm from flange	N	29.3	39.4	45.9
Gearhead length L1'	mm	79	94	107
Weight	g			

Number of stages	1	2	3						
Reduction	X:1	3.9, 5.3, 6.6	16, 21, 26, 28, 35, 44	62, 83, 103,					
Absolute reduction: (see online)				111, 138, 150, 172, 186, 231					

Version

Flange

Shaft

Shaft seal

Standard flange

Length/flat face/cross hole

EC motor	Nº of stages [opt.]	
ECX SPEED 22 M	1-3	227-228
ECX SPEED 22 L	1-3	231-232
ECX PRIME 22 L STEC*	1-3	239

¹This length may vary depending on the configuration and choice of motor. The effective length is calculated at the end of the configuration process.