



maxon thruster 30

Specification: 533815
aquaticsolutions.maxongroup.com

Contact us: aquaticsolutions@maxonmotor.com

maxon thruster 30 175 Watt

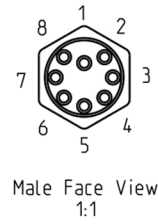
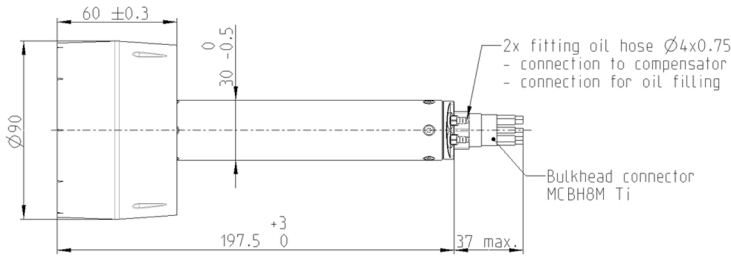

Connections	
Winding 1	1
Winding 2	2
Winding 3	3
Hall 1	4
Hall 2	5
Hall 3	6
GND	7
V Hall 3... 24 VDC	8

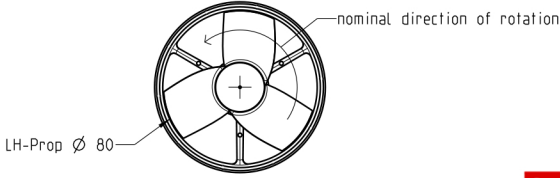

	Article number	
	Single	with MC30
Left hand propeller direction MT30 LH	533815	605573
Right hand propeller direction MT30 RH	620036	620086

Thruster specification		
1	Weight in air	gr 450
2	Weight in water (salt water)	gr 262
3	Prop diameter	mm 80
4	Number of blades	pcs 3
5	Depth rating	m 6.000
7	Pressure compensation (over pressure)	bar 0.1 - 0.7
8	Max. forward bollard thrust	kg 6.3
9	Continuous forward bollard thrust	kg 3.7
10	Max. reverse bollard thrust	kg 4.4
11	Continuous reverse bollard thrust	kg 3.1
12	Max. efficiency	% 80
13	Connector (basic version)	MCBH8 Male ti
14	Nominal Voltage	V 48
15	Max. current	A 16
16	No load current @ 5000 rpm motor	A 1
17	Max. stall current	A 140
18	Continuous current	A 10.3
19	Max. motor temperature	$^{\circ}\text{C}$ 110
20	Continuous motor temperature	$^{\circ}\text{C}$ 70

Bollard thrust

Motor Current

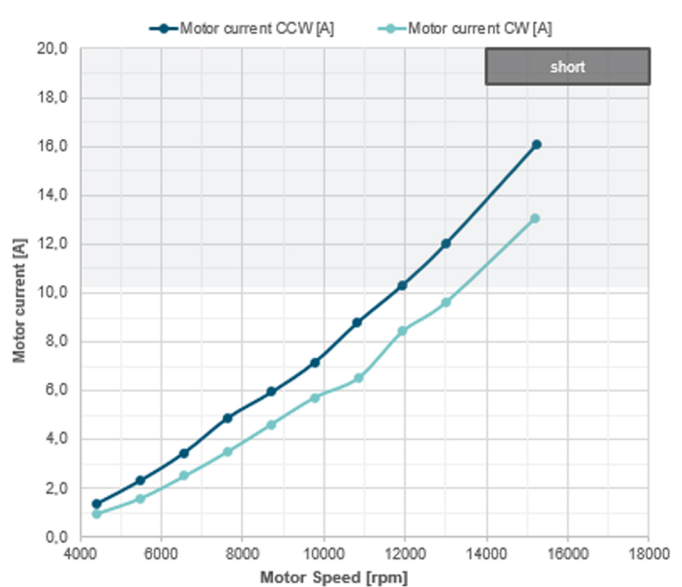
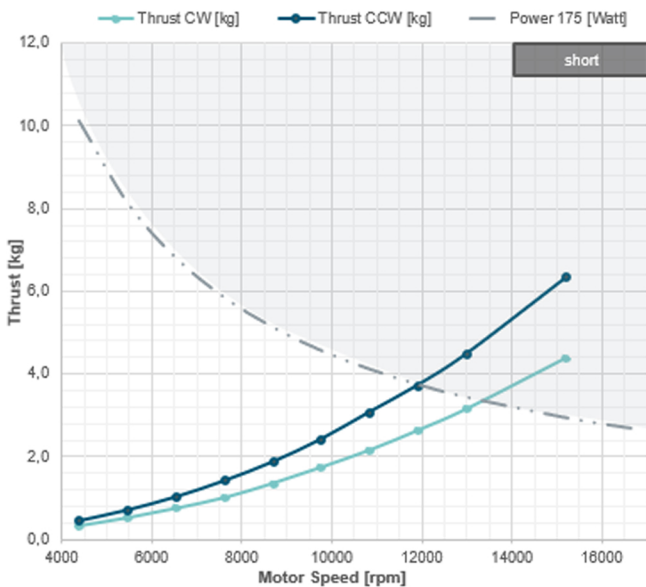

CCW = Counterclockwise (forward)
CW = Clockwise (reverse)